



THE SWEETWATER ARBORETUM AT ENGLEMAN PARK is a hidden gem, peacefully located off the beaten path. With a collection of over 30 specimens of notable tree species, some older than 150 years, this public city park offers free parking, a shaded pavilion, a gazebo, ADA accessible restroom facilities, and a children's playground designed with ages 2-5 in mind.

Residents and visitors are invited to explore this serene natural oasis and observe a wide diversity of Tennessee trees in a relatively compact area. The Arboretum is a resource for field trips and outdoor classes, as well as a



Pink Flowering Dogwood

destination for old-fashioned family outings. The public is welcome to enjoy the facilities free of charge, including reserving the pavilions for reunions, showers, parties, and other group events throughout the year. (Call City Hall to reserve the pavilion, 423-337-6979.)



American Holly with winter berries

Autumn foliage of Sugar Maple



DIRECTIONS: From US Hwy 11 in downtown Sweetwater, turn onto Monroe Street at the traffic light and follow it less than 1 mile to the Park.

www.sweetwatertn.net

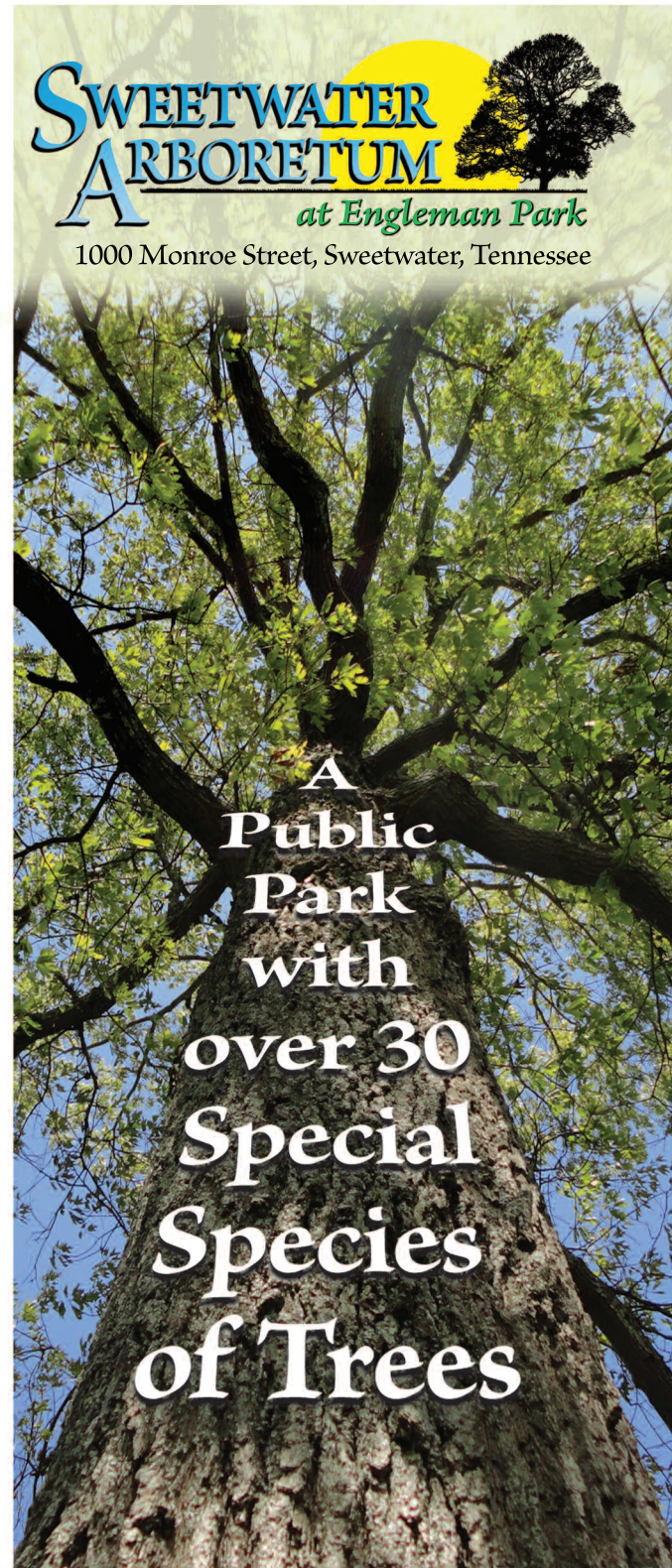

SWEETWATER ARBORETUM
at Engleman Park
 1000 Monroe Street, Sweetwater, Tennessee

**A
 Public
 Park
 with
 over 30
 Special
 Species
 of Trees**

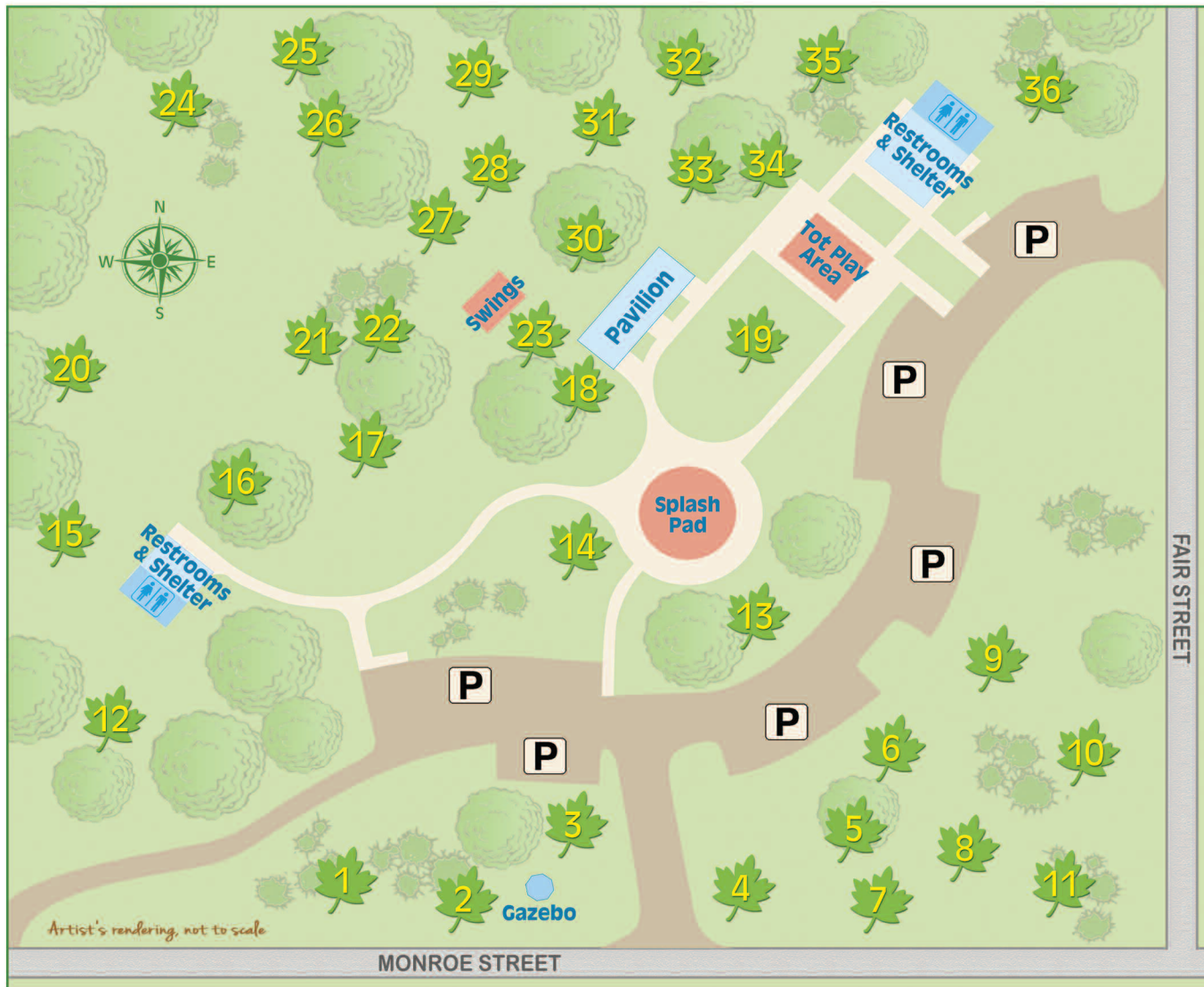

Special Trees at Sweetwater Arboretum

Common Name
Botanical Name

- 1 Tulip-Poplar (TN State Tree)
Liriodendron tulipifera
- 2 Crapemyrtle
Lagerstroemia indica
- 3 Post Oak
Quercus stellata
- 4 Ginkgo
Ginkgo biloba

- 5 Overcup Oak
Quercus lyrata
- 6 Yoshino Cherry
Prunus x yedoensis
- 7 Flowering Dogwood
Cornus florida
- 8 Red Maple
Acer rubrum
- 9 Bald Cypress
Taxodium distichum
- 10 White Fringetree
Chionanthus virginicus
- 11 Hackberry
Celtis occidentalis
- 12 American Hornbeam
Carpinus caroliniana

- 13 American Beech
Fagus grandifolia
- 14 Black Walnut
Juglans nigra
- 15 Black Oak
Quercus velutina
- 16 Dawn Redwood
Metasequoia glyptostroboides
- 17 Sugar Maple
Acer saccharum
- 18 Mockernut Hickory
Carya tomentosa
- 19 Eastern Hophornbeam
Ostrya virginiana
- 20 Southern Magnolia
Magnolia grandiflora

- 21 Eastern White Pine
Pinus strobus
- 22 Magnolia Little Gem
Magnolia grandiflora
'Little Gem'
- 23 Southern Red Oak
Quercus falcata
- 24 Eastern Redcedar
Juniperus virginiana
- 25 Eastern Redbud
Cercis canadensis
- 26 Weeping Willow
Salix babylonica
- 27 White Oak
Quercus alba
- 28 Swamp White Oak
Quercus bicolor

- 29 American Sycamore
Platanus occidentalis
- 30 Norway Spruce
Picea abies
- 31 Sweetgum
Liquidambar styraciflua
- 32 American Elm 'Princeton'
Ulmus americana
- 33 American Holly
Ilex opaca
- 34 Pin Oak
Quercus palustris
- 35 Green Giant Arborvitae
Thuja plicata x standishii
'Green Giant'
- 36 Japanese Maple
Acer palmatum

The Sweetwater Arboretum is open from dawn 'til dusk every day of the year. Take a casual stroll or a brisk walk along the paved path and you'll find stone markers at the base of many trees to identify their species. In every season, there's a special beauty: flowering trees of springtime, lush greenery of summer, spectacular colors of fall foliage, stately winter silhouettes.



Hackberry
Celtis occidentalis



Tulip Poplar flower

Leashed dogs are welcome and a dog station is provided to help you keep the park clean and enjoyable for all.

View the Arboretum map online at:
www.sweetwatertn.net

ENGLEMAN PARK

Engleman Park was purchased for \$640 in 1940 by the City of Sweetwater, which had passed an ordinance to establish a city park in 1936. The park area was covered with huge oak trees at the time. The park was named for J.G. (Major) Engleman, who served the City of Sweetwater as Recorder for 47 years, from 1918 until 1965.

A major renovation of Engleman Park was performed in 2010, adding the playground facilities and updating the pavilions and parking areas through the State of Tennessee LPRF grant program. In 2019, another LPRF grant added a splash pad, third pavilion, and swings. Sweetwater's full time parks and recreation staff maintains the property.

Many lifelong Sweetwater residents recall fond memories of childhood outings to Engleman Park for family picnics and gatherings. By establishing the Arboretum, the Sweetwater Tree Board hopes this urban forest will provide enjoyment now and to future generations.

The Sweetwater Tree Board's Mission Statement:
We will serve as advocates for the health of the urban forest of Sweetwater by communicating with residents and business with regards to proper selection, planting, and maintenance of trees for now and for generations to come.